

### Caractéristiques / dimensions des profilés Alpha

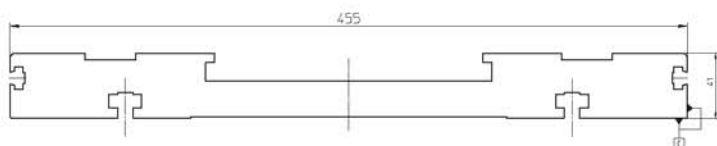

**C** Zone de référence coté C / Datum edge side C

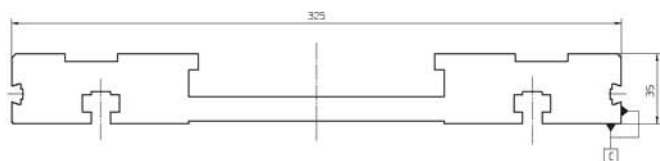
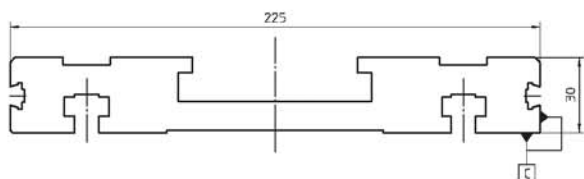
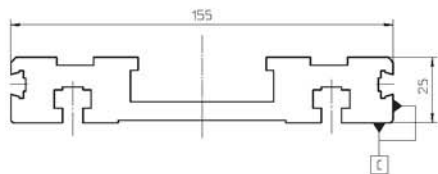
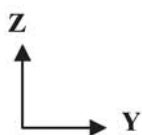
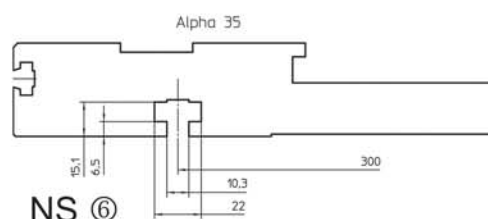
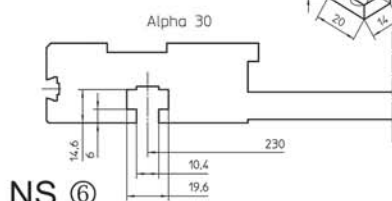
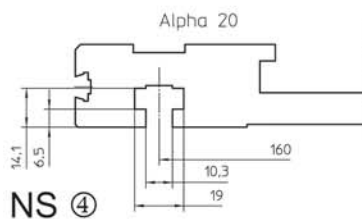
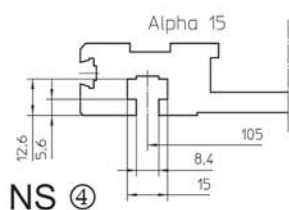

#### Profilé / Profile Alpha 15B

|  |           |                    |
|--|-----------|--------------------|
| Masse spécifique / Specific mass   | : 6,29    | [Kg/m]             |
| Aire de la Section / Area of cross section   | : 2330    | [mm <sup>2</sup> ] |
| Moment d'inertie géométrique I <sub>y</sub> / Geometrical moment of inertia I <sub>y</sub> | : 127491  | [mm <sup>4</sup> ] |
| Moment d'inertie géométrique I <sub>z</sub> / Geometrical moment of inertia I <sub>z</sub> | : 5734884 | [mm <sup>4</sup> ] |
| Section W <sub>y</sub> / Section modulus W <sub>y</sub>                                    | : 9392    | [mm <sup>3</sup> ] |
| Section W <sub>z</sub> / Section modulus W <sub>z</sub>                                    | : 73862   | [mm <sup>3</sup> ] |

#### Profilé / Profile Alpha 20B

|  |            |                    |
|--|------------|--------------------|
| Masse spécifique / Specific mass   | : 12,48    | [Kg/m]             |
| Aire de la Section / Area of cross section   | : 4624     | [mm <sup>2</sup> ] |
| Moment d'inertie géométrique I <sub>y</sub> / Geometrical moment of inertia I <sub>y</sub> | : 347444   | [mm <sup>4</sup> ] |
| Moment d'inertie géométrique I <sub>z</sub> / Geometrical moment of inertia I <sub>z</sub> | : 22780835 | [mm <sup>4</sup> ] |
| Section W <sub>y</sub> / Section modulus W <sub>y</sub>                                    | : 21453    | [mm <sup>3</sup> ] |
| Section W <sub>z</sub> / Section modulus W <sub>z</sub>                                    | : 202367   | [mm <sup>3</sup> ] |

#### Profilé / Profile Alpha 30B

|  |            |                    |
|--|------------|--------------------|
| Masse spécifique / Specific mass   | : 20,24    | [Kg/m]             |
| Aire de la Section / Area of cross section   | : 7498     | [mm <sup>2</sup> ] |
| Moment d'inertie géométrique I <sub>y</sub> / Geometrical moment of inertia I <sub>y</sub> | : 742188   | [mm <sup>4</sup> ] |
| Moment d'inertie géométrique I <sub>z</sub> / Geometrical moment of inertia I <sub>z</sub> | : 83000941 | [mm <sup>4</sup> ] |
| Section W <sub>y</sub> / Section modulus W <sub>y</sub>                                    | : 38253    | [mm <sup>3</sup> ] |
| Section W <sub>z</sub> / Section modulus W <sub>z</sub>                                    | : 510463   | [mm <sup>3</sup> ] |

#### Profilé / Profile Alpha 35B

|  |             |                    |
|--|-------------|--------------------|
| Masse spécifique / Specific mass   | : 38,06     | [Kg/m]             |
| Aire de la Section / Area of cross section   | : 14099     | [mm <sup>2</sup> ] |
| Moment d'inertie géométrique I <sub>y</sub> / Geometrical moment of inertia I <sub>y</sub> | : 1732801   | [mm <sup>4</sup> ] |
| Moment d'inertie géométrique I <sub>z</sub> / Geometrical moment of inertia I <sub>z</sub> | : 279835483 | [mm <sup>4</sup> ] |
| Section W <sub>y</sub> / Section modulus W <sub>y</sub>                                    | : 75532     | [mm <sup>3</sup> ] |
| Section W <sub>z</sub> / Section modulus W <sub>z</sub>                                    | : 1228843   | [mm <sup>3</sup> ] |